

Unit: mm

SCREW SIZE		BALL DIA.	EFFECTIVE TURNS	BASIC RATE LOAD(kgf)		NUT		KEYWAY			STIFFNESS	
O.D.	LEAD			Dynamic (1×10 <sup>5</sup> REV.) Ca	Static Co	Dg6	L	K	W	H	kgf/μm	
16	5	3.175	3	765	1240	28	75	20	3	1.8	35	
			4	980	1650		85				47	
20	5	3.175	3	860	1710	34	75	20	3	1.8	43	
			4	1100	2280		85				56	
	6	3.969	3	1080	2050	34	87	20	4	2.5	43	
			4	1380	2730		103				56	
25	5	3.175	3	980	2300	40	75	20	4	2.5	51	
			4	1250	3070		85				67	
	6	3.969	3	1275	2740	40	87	20	4	2.5	52	
			4	1630	3650		103				68	
32	5	3.175	3	1095	3060	48	75	20	4	2.5	63	
			4	1400	4080		85				82	
			6	1980	6120		105				122	
			6	1500	3750		87				65	
	6	3.969	4	3	1920	5000	50	103	25	5	3.0	86
				4	2720	7500		127				125
				6	1820	4230		109				66
				4	2330	5640		127				86
8	4.762	4	3	2605	5310	50	135	25	6	3.5	67	
			4	3340	7080		155				89	
40	5	3.175	4	1575	5290	55	85	20	4	2.5	100	
			6	2230	7940		105				147	
			4	2130	6410		103				103	
			6	3020	9620		127				149	
	8	4.762	4	4	2720	7620	60	127	25	5	3.0	105
				6	3850	11430		161				154
	10	6.35	3	3	3010	7100	65	135	25	6	3.5	82
				4	3850	9470		155				107

## RDIC

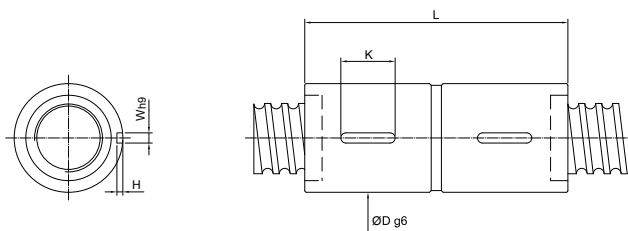

Unit: mm

SCREW SIZE		BALL DIA.	EFFECTIVE TURNS	BASIC RATE LOAD(kgf)		NUT		KEYWAY			STIFFNESS
O.D.	LEAD			Dynamic (1×10 <sup>6</sup> REV.) Ca	Static Co	Dg6	L	K	W	H	kgf/μm
50	5	3.175	4	1730	6750	66	85	20	4	2.5	119
			6	2450	10130		105	25			174
	6	3.969	4	2380	8250	66	103	25	5	3.0	123
			6	3370	12380		127	32			181
	8	4.762	4	3010	9610	70	127	32	5	3.0	125
			6	4260	14420		161	32			185
10	6.35	3	3430	9300	74	135	32	6	3.5	99	
		4	4390	12400		155	32			129	
12	7.938	4	6220	18600	75	197	40	6	3.5	191	
		3	4510	11150		161	40			101	
			4	5770	14870		185	40			132
			6	2610	10550		80	106			25
63	6	3.969	4	3700	15830	80	130	32	6	3.5	217
			6	3375	12200		82	131			32
	8	4.762	4	4780	18300	82	165	40	6	3.5	222
			6	5020	16450		85	160			32
	10	6.35	4	7110	24680	85	202	40	8	4.0	232
			6	6580	19430		90	185			40
12	7.938	4	9320	29150	90	238	50	8	4.0	236	
		6	6580	19430		90	185			40	161
80	10	6.35	4	5510	21200	105	160	32	8	4.0	190
			6	7810	31800		202	40			280
	12	7.938	4	7500	25700	110	185	40	8	4.0	196
			6	10620	38550		238	50			288
	20	9.525	3	9770	31700	115	245	50	10	5.0	193
			4	12510	42270		289	63			254
100			3	4760	20090		132				173
			4	6090	26790		125	164			50
	10	6.35	5	7380	33490		174				281
			6	8630	40190		204				
	16	9.525	4	14440	54960		240				266
			5	17490	68700		135	274			63
20	9.525	6	20460	82440		306				391	
		4	14440	54960			284				
			5	17490	68700		324	63			329
			6	20460	82440			366			