

FSDC

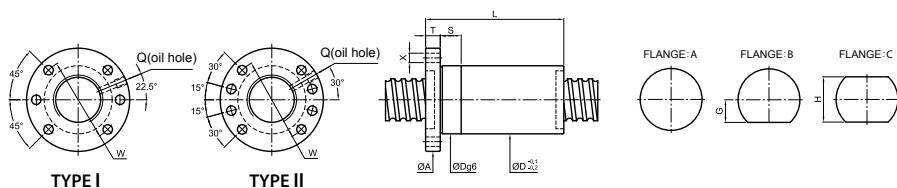

Unit: mm

O.D.	LEAD	BALL DIA.	EFFECTIVE TURNS	MODIFIED LOAD CAPACITY (kgf)		NUT		FLANGE						FIT S	OIL HOLE Q	BOLT X	STIFFNESS kgf/μm
				Dynamic (1×10 ⁶ REV.)	Static Cam Coam	Dg6	L	A	T	W	G	H	TYPE				
12	4	2.381	3	610	1190	24	28	44	10	34	16	32	I	10	M6×1P	4.5	20
	5		3	610	1190		32										20
	10		3	590	1160		45										20
	20		2	390	770		54										14
14	4	2.381	3	680	1430	26	28	46	10	36	16	32	I	10	M6×1P	4.5	23
	5	3.175	3	820	1520	28	32	49	10	39	16	32	I	10	M6×1P	4.5	25
15	5	3.175	3	850	1640	29	35	51	10	39	16	38	I	10	M6×1P	5.5	26
	10		3	840	1610		47										26
	20		2	560	1050		58										18
16	5	3.175	3	890	1760	29	41	51	10	39	16	38	I	10	M6×1P	5.5	27
	10		3	870	1740		50										27
	16		2	600	1150		51										19
20	4	2.381	3	780	2000	32	28	54	12	42	19	38	I	12	M6×1P	5.5	29
	5		4	1300	3030		40										43
	10	3.175	3	990	2220	36	47	62	12	49	19	38	I	12	M6×1P	6.6	33
	20	2	670	1450	56		23										
	6	3.969	3	1540	3310	37	38	62	12	49	19	38	I	12	M6×1P	6.6	34
	8		3	1540	3300		45										34
10	4.762	4	2560	5530	40	62	62	12	51	24	48	I	15	M6×1P	6.6	47	
25	4	2.381	3	870	2560	36	28	62	12	49	19	38	I	12	M6×1P	6.6	34
	5		4	1440	3840		41										50
	10	3	1100	2810	40	50	62	12	51	24	48	I	15	M6×1P	6.6	38	
	15	4	1410	3780		81										50	
	20	2	750	1840	43	60	64	12	51	22	44	I	15	M6×1P	6.6	26	
	25	2	730	1810		71										26	
	6	3.969	4	2250	5710	43	45	64	12	51	22	44	I	15	M6×1P	6.6	53
	12		4	2240	5660		70										53
	25	2	1160	2720	45	70	65	15	54	25.5	51	I	15	M6×1P	6.6	28	
	8	4	2880	6890		55										28	
	10	4.762	4	2880	6870	45	63	65	15	54	25.5	51	I	15	M6×1P	6.6	55
	16		4	2830	6790		85										55
20	2		1470	3180	61		29										
10	6.35		5	5050	11500		51										78

Coam and Cam are the modified static and dynamic load capacities, calculated according to ISO-3408-5

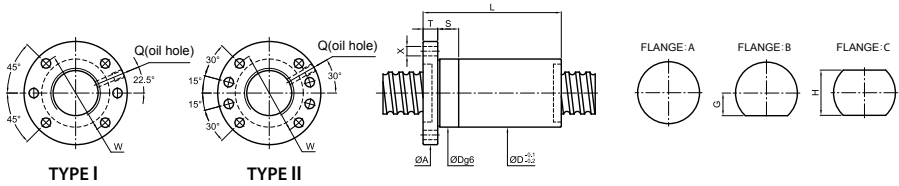

Unit: mm

SCREW SIZE	BALL DIA.	EFFECTIVE TURNS	MODIFIED LOAD CAPACITY (kgf)		NUT		FLANGE						FIT S	OIL HOLE Q	BOLT X	STIFFNESS	
			Dynamic (1×10 ⁶ REV.)	Static	Dg6	L	A	T	W	G	H	TYPE					kgf/μm
28	5	3.175	5	1850	5460	43	48	65	12	51	24	48	I	15	M8×1P	6.6	67
	6	3.969	5	2880	7980	46	52	66	12	50	26	52	I	15	M8×1P	6.6	70
	8		3	2350	5720	46	52	66	12	50	26	52	I	15	M8×1P	6.6	46
	10	4.762	3	2340	5710	48	52	74	12	60	30	60	I	15	M8×1P	6.6	46
	16		5	3680	9690	102	52	74	12	60	30	60	I	15	M8×1P	6.6	73
	10	6.35	5	5280	12530	54	78	87	16	72	34.5	69	I	15	M8×1P	9	77
12	5		5270	12500	88	78	87	16	72	34.5	69	I	15	M8×1P	9	77	
32	5	3.175	4	1610	4970	50	41	87	16	72	34.5	69	I	15	M8×1P	9	61
	6	3.969	5	3050	9140	52	41	87	16	72	34.5	69	I	15	M8×1P	9	77
	10		4	2550	7500	53	62	87	16	72	34.5	69	I	15	M8×1P	9	63
	32	2	1300	3540	84	62	87	16	72	34.5	69	I	15	M8×1P	9	40	
	8	4.762	5	3900	10930	67	62	87	16	72	34.5	69	I	15	M8×1P	9	80
	10		5	3890	10910	77	62	87	16	72	34.5	69	I	15	M8×1P	9	80
	12	5.556	5	3890	10890	53	87	87	16	72	34.5	69	I	15	M8×1P	9	80
	15		5	3860	10850	116	87	87	16	72	34.5	69	I	15	M8×1P	9	80
	20	6.35	2	1700	4230	70	87	87	16	72	34.5	69	I	15	M8×1P	9	34
	32		2	1640	4120	84	87	87	16	72	34.5	69	I	15	M8×1P	9	34
	10	5.556	5	4900	13360	78	87	87	16	72	34.5	69	I	15	M8×1P	9	84
	12		5	4890	13340	88	87	87	16	72	34.5	69	I	15	M8×1P	9	84
	16	6.35	5	4860	13280	107	87	87	16	72	34.5	69	I	15	M8×1P	9	79
	20		3	3140	8110	87	87	87	16	72	34.5	69	I	15	M8×1P	9	53
	10	6.35	5	5720	14490	78	87	87	16	72	34.5	69	I	15	M8×1P	9	85
	12		5	5710	14470	88	87	87	16	72	34.5	69	I	15	M8×1P	9	85
16	6.35	4	4520	11100	92	87	87	16	72	34.5	69	I	15	M8×1P	9	69	
20		3	3530	8340	88	87	87	16	72	34.5	69	I	15	M8×1P	9	54	

Coam and Cam are the modified static and dynamic load capacities,calculated according to ISO-3408-5

FSDC

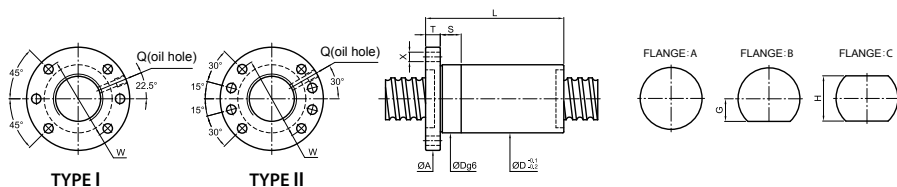

Unit: mm

SCREW SIZE	BALL LEAD	BALL DIA.	EFFECTIVE TURNS	MODIFIED LOAD CAPACITY (kgf)		NUT		FLANGE						FIT S	OIL HOLE Q	BOLT X	STIFFNESS kgf/μm	
				Dynamic (1×10 ⁶ REV.) Cam	Static Coam	Dg6	L	A	T	W	G	H	TYPE					
36	8	4.762	5	4170	12580	56	63	80	11	68	34	68	I	15	M8×1P	9	86	
	10		5	6050	16460		78											93
	12		5	6080	16430		88											93
	16	6.35	5	6050	16360	61	109	91	18	76	34	68	II	15	M8×1P	9	93	
	20		4	4910	12890		109											76
	36		2	2570	6250		95											41
38	10	6.35	5	6260	17740		80										97	
	12		5	6260	17410		88											97
	16		5	6220	17350	63	109	93	18	78	35	70	II	20	M8×1P	9	97	
	40		3	3830	10220		142											71
40	5	3.175	4	1760	6260	58	42	91	18	76	34	68	II	15	M8×1P	9	71	
	6	3.969	5	3420	11810	58	52	91	18	76	34	68	II	15	M8×1P	9	92	
	8	4.762	4	3610	11260	60	56	91	18	76	34	68	II	15	M8×1P	9	77	
	10	6.35	5	6430	18440		78										101	
	12		5	6420	18410		88											101
	15		5	6380	18350		103	95	18	80	36	72	II	20	M8×1P	9	101	
	16		5	6390	18330		108											101
	20		4	5190	14450													82
	40		2	2700	6950		110	98	18	83	37	74	II	20	M8×1P	11	43	
	12	7.144	5	7530	20800													103
16	5		7500	20730	70	90	98	18	83	37	74	II	20	M8×1P	11	103		

Coam and Cam are the modified static and dynamic load capacities,calculated according to ISO-3408-5

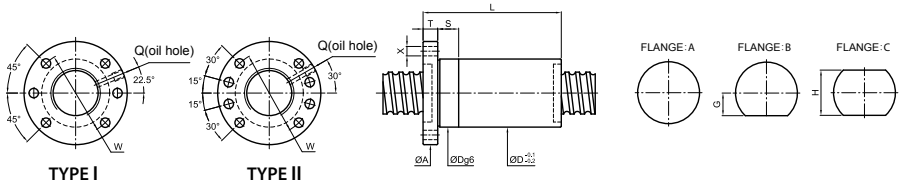

Unit: mm

O.D.	SCREW SIZE		EFFECTIVE TURNS	MODIFIED LOAD CAPACITY (kgf)		NUT		FLANGE						FIT	OIL HOLE	BOLT	STIFFNESS
	LEAD	BALL DIA.		Dynamic (1×10 ⁶ REV.)	Static	Dg6	L	A	T	W	G	H	TYPE				
45	8	4.762	4	3770	12580	66	55	98	18	83	37	74	II	20	M8×1P	11	84
	10		5	6910	21330		78										110
	12	6.35	5	6910	21310	70	89	105	18	88	40	80	II	20	M8×1P	11	110
	16		5	6880	21250		111										110
	12	7.144	5	7930	23300	73	88	105	18	88	40	80	II	20	M8×1P	11	113
	20		4	6440	18340		110										91
50	5	3.175	5	2360	9950	70	48	105	18	88	40	80	II	20	M8×1P	11	105
	8	4.762	5	4780	17550	70	64	105	18	88	40	80	II	20	M8×1P	11	109
	10		5	7160	23320		78										119
	12	6.35	5	7150	23300	75	90	118	18	100	46	92	II	20	M8×1P	11	119
	16		5	7120	23250		109										119
	20		3	4460	13520		95										74
20	7.938	4	7810	22680	80	114	121	18	104	50	100	II	25	M8×1P	11	101	
55	12	6.35	5	7340	25280	80	96	118	18	100	46	92	II	20	M8×1P	11	128
63	10	6.35	5	7800	29210	88	84	135	22	115	50	110	II	20	M8×1P	11	141
	16	9.525	5	13640	43620	102	116	147	20	127	56	112	II	25	M8×1P	14	167
80	20		5	15350	56760		143										196
	25	9.525	4	12530	44860	118	146	165	25	145	65	130	II	25	M8×1P	14	159
	30		3	9610	32980		134										121

Coam and Cam are the modified static and dynamic load capacities,calculated according to ISO-3408-5