

FSWW

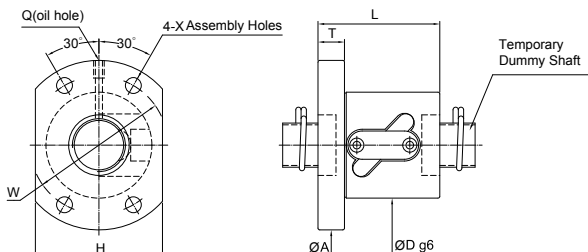

Unit: mm

SCREW SIZE		BALL DIA.	EFFECTIVE TURNS circuit x row	BASIC RATE LOAD(kgf)		BALLNUT DIMENSION										
O.D.	LEAD			Dynamic (1x10 ⁶ REV) Ca	Static Co	O.D. D	Length L	Flange			Assembly Hole X	Oil Hole Q	STIFFNESS kgf/µm	Nut Model NO.		
12	4	2.381	2.5x1	285	533	30	40	52	10	40	31	4.5	M6x1P	9	FSWW1204A-2.5P	
	5	2	2.5x1	270	350	26	40	47	10	37	30	4.5	M6x1P	8.2	FSWW1205Z-2.5P	
14	4	2.381	3.5x1	500	1100	35	42	57	10	45	40	4.5	M6x1P	15	FSWW1404A-3.5P	
	5	3.175	2.5x1	515	990	40	40	57	10	45	40	4.5	M6x1P	11	FSWW1405B-2.5P	
15	10	3.175	2.5x1	440	680	34	55	57	10	45	34	5.5	M6x1P	12	FSWW1510B-2.5P	
16	4	2.381	1.5x2	540	1260	34	41	57	11	45	34	5.5	M6x1P	15	FSWW1604A-3.0P	
			2.5x1	460	1050									13	FSWW1604A-2.5P	
			3.5x1	610	1470									17	FSWW1604A-3.5P	
	5	3.175	1.5x2	640	1370	40	41	63	11	51	42	5.5	M6x1P	15	FSWW1605B-3.0P	
			2.5x1	550	1140									13	FSWW1605B-2.5P	
			2.5x2	1000	2280									23	FSWW1605B-5.0P	
3.5x1	730	1600	17	FSWW1605B-3.5P												
10	3.175	2.5x1	550	990	40	56	63	11	51	42	5.5	M6x1P	13	FSWW1610B-2.5P		
20	4	2.381	1.5x2	740	1870	40	42	67	11	55	52	5.5	M6x1P	19	FSWW2004A-3.0P	
			2.5x1	630	1560									16	FSWW2004A-2.5P	
			2.5x2	1140	3120									30	FSWW2004A-5.0P	
			3.5x1	840	2180									22	FSWW2004A-3.5P	
	5	3.175	1.5x2	730	1740	44	42	67	11	55	52	5.5	M6x1P	18	FSWW2005B-3.0P	
			2.5x1	625	1450									15	FSWW2005B-2.5P	
			2.5x2	1130	2900									28	FSWW2005B-5.0P	
			3.5x1	830	2030									20	FSWW2005B-3.5P	
10	4.762	2.5x1	1100	2200	52	61	82	12	67	64	6.6	M6x1P	16	FSWW2010D-2.5P		

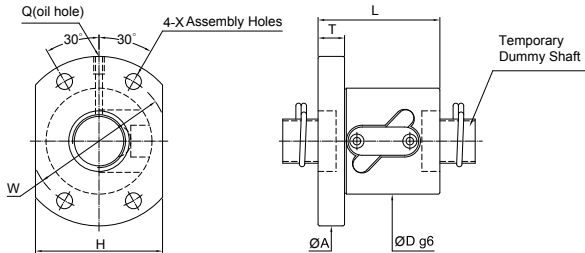

Unit: mm

SCREW SIZE		BALL DIA.	EFFECTIVE TURNS circuit x row	BASIC RATE LOAD(kgf)		BALLNUT DIMENSION													
O.D.	LEAD			Dynamic (1x10 ⁶ REV.) Ca	Static Co	O.D. D	Length L	Flange				Assembly Hole X	Oil Hole Q	STIFFNESS kgf/µm	Nut Model NO.				
25	4	2.381	1.5x2	980	2640		44											FSWW2504A-3.0P	
			2.5x1	840	2200		40												FSWW2504A-2.5P
			2.5x2	1520	4400		49		69	11	57	52	5.5		M6x1P		38		FSWW2504A-5.0P
			3.5x1	1120	3080		42												FSWW2504A-3.5P
	5	3.175	1.5x2	840	2200		45												FSWW2505B-3.0P
			2.5x1	720	1830		41												FSWW2505B-2.5P
			2.5x2	1120	3710		50		73	11	61	56	6.6		M6x1P		37		FSWW2505B-5.0P
			3.5x1	960	2560		46												FSWW2505B-3.5P
	10	4.762	1.5x2	1490	3340		71												FSWW2510D-3.0P
			2.5x1	1270	2780		58		65	15	71	64	6.6		M6x1P		20		FSWW2510D-2.5P
			3.5x1	1700	3890		75												FSWW2510D-3.5P
	10	6.35	2.5x1	1720	3590		69		96	15	78	72	9		M6x1P		21		FSWW2510F-2.5P
2.5x2			3200	7170		97												FSWW2510F-5.0P	
28	5	3.175	1.5x2	910	2470		46											FSWW2805B-3.0P	
			2.5x1	780	2060		42												FSWW2805B-2.5P
			2.5x2	1410	4120		56		83	12	69	62	6.6		M8x1P		33		FSWW2805B-5.0P
			3.5x1	1040	2880		47												FSWW2805B-3.5P
32	5	3.175	1.5x2	990	2830		47											FSWW3205B-3.0P	
			2.5x1	850	2360		43												FSWW3205B-2.5P
			2.5x2	1540	4720		58		85	12	71	64	6.6		M8x1P		41		FSWW3205B-5.0P
			2.5x3	2180	7080		72												FSWW3205B-7.5P
	10	6.35	3.5x1	1130	3300		47												FSWW3205B-3.5P
			1.5x2	2260	5620		78												FSWW3210F-3.0P
			2.5x1	1930	4680		67		103	15	85	78	9		M6x1P		25		FSWW3210F-2.5P
			2.5x2	3130	9410		97												FSWW3210F-5.0P
			3.5x1	2580	6550		78										FSWW3210F-3.5P		

FSWW

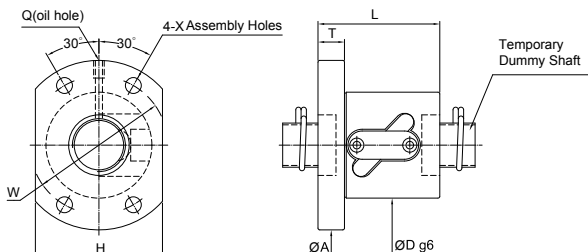

SCREW SIZE		BALL DIA.	EFFECTIVE TURNS circuit × row	BASIC RATE LOAD (kgf)		BALLNUT DIMENSION												
O.D.	LEAD			Dynamic (1×10 ⁶ REV.) Ca	Static Co	O.D. D	Length L	Flange				Assembly Hole X	Oil Hole Q	STIFFNESS kgf/μm	Nut Model NO.			
36	10	6.35	1.5x2	2170	6480	81										30	FSWW3610F-3.0P	
			2.5x2	3370	10800	70	99	110	17	90	82	11	M6x1P	29	FSWW3610F-5.0P			
			3.5x1	2480	7560	81								35	FSWW3610F-3.5P			
40	5	3.175	1.5x2	1180	3560	54										37	FSWW4005B-3.0P	
			2.5x1	1010	2970	48										32	FSWW4005B-2.5P	
			2.5x2	1830	5940	67	60	101	15	83	78	9	M8x1P	60	FSWW4005B-5.0P			
			2.5x3	2600	8910	75										87	FSWW4005B-7.5P	
			3.5x1	1350	4160	50										43	FSWW4005B-3.5P	
40	10	6.35	1.5x2	2270	7200	81										39	FSWW4010F-3.0P	
			2.5x1	1940	6000	71										34	FSWW4010F-2.5P	
			2.5x2	3520	12000	76	100	116	17	96	88	11	M6x1P	59	FSWW4010F-5.0P			
			3.5x1	2590	8400	81										45	FSWW4010F-3.5P	
50	10	6.35	1.5x2	2510	9000	81										31	FSWW5010F-3.0P	
			2.5x1	2150	7500	71											39	FSWW5010F-2.5P
			2.5x2	3900	15000	101											72	FSWW5010F-5.0P
			2.5x3	5520	22500	131	128	18	108	100	11	M6x1P	105	FSWW5010F-7.5P				
			3.5x1	2870	10500	81											53	FSWW5010F-3.5P
			3.5x2	4940	21000	126											98	FSWW5010F-7.0P

Note:

Stiffness of nut:

Stiffness values listed above are derived from theoretical formula to the elastic deformation between thread grooves and balls while axial load is 30% dynamic load rating.