

# FDVE

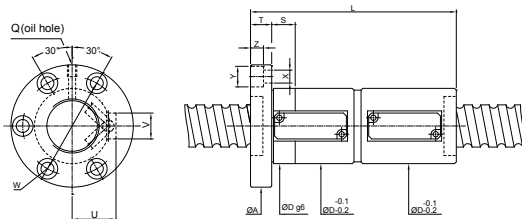

Unit: mm

SCREW SIZE	BALL DIA.	EFFECTIVE TURNS circuit × row	BASIC RATE LOAD (kgf)		NUT		FLANGE		FIT		BOLT		RETURN TUBE		OIL HOLE	STIFFNESS														
			Dynamic (1×10 <sup>6</sup> REV.) Ca	Static Co	Dg6	L	A	T	W	S	X	Y	Z	U	V		Q													
12	10	2.381	2.5×1	420	720	25	102	48	10	36	10	4.5	8	4.4	14	12	M6×1P	30												
	10	3.969	2.5×1	1210	2380	38	113	62	13	50	10	5.5	9.5	5.5	23	15	M6×1P	51												
			3.5×1	1580	3230													68												
	16	3.969	1.5×1	830	1530	38	128	62	13	50	10	5.5	9.5	5.5	23	15	M6×1P	35												
2.5×1			1210	2380	51																									
20	3.969	1.5×1	830	1530	38	130	62	13	50	10	5.5	9.5	5.5	23	15	M6×1P	35													
			1.5×1	920													1930	42	126	68	15	55	15	6.6	11	6.6	26	14	M6×1P	41
			2.5×1	1340													3000													158
			1.5×1	1170													2300	154												
25	4.762	2.5×1	1710	3580	44	194	72	15	59	15	6.6	11	6.5	27	16	M6×1P	63													
		3.5×1	2220	4860													234													
		1.5×1	1010	2480													130	162	78	15	63	15	6.6	11	6.6	29	15	M8×1P	49	
		2.5×1	1470	3860																									173	
3.5×1	1910	5240	194																											
5×1	2340	6610	226																											
32	16	3.969	2.5×1	2830	8200	57	205	98	18	77	20	11	17.5	11	34	22	M8×1P	80												
			3.5×1	3680	11120													237												
			5×1	4490	14050													237												
			1.5×1	1010	2480													133												
	20	3.969	2.5×1	1470	3860	49	173	78	15	63	15	6.6	11	6.6	29	15	M8×1P	73												
			3.5×1	1910	5240													213												
			5×1	2350	6610													253												
			2.5×1	2830	8200													204												
20	6.35	3.5×1	3680	11120	57	244	98	18	77	20	11	17.5	11	34	22	M8×1P	105													
		5×1	4490	14050													284													

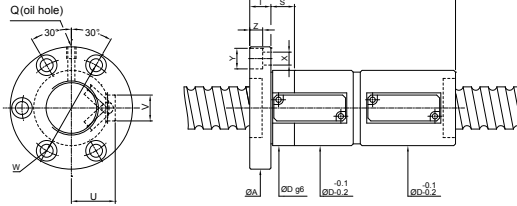

Unit: mm

SCREW SIZE		BALL DIA.	EFFECTIVE TURNS circuit × row	BASIC RATE LOAD (kgf)		NUT		FLANGE			FIT		BOLT		RETURN TUBE		OIL HOLE	STIFFNESS	
O.D.	LEAD			Dynamic (1×10 <sup>6</sup> REV.) Ca	Static Co	Dg6	L	A	T	W	S	X	Y	Z	U	V	Q	kgf/μm	
36	10	6.35	3.5×1	3890	9390	60	155	100	18	80	20	11	17.5	11	36	22	M8×1P	115	
			5×1	4750	11860		175											143	
	12	6.35	2.5×1	2990	6920	60	152	100	18	80	20	11	17.5	11	36	22	M8×1P	88	
			3.5×1	3890	9390		176											115	
	16	6.35	2.5×1	2990	6920	60	173	100	18	80	20	11	17.5	11	36	22	M8×1P	88	
			3.5×1	3890	9390		205											115	
	20	6.35	1.5×1	2050	4450	60	164	100	18	80	20	11	17.5	11	36	22	M8×1P	59	
			2.5×1	2990	6920		204											88	
			3.5×1	3890	9390		244											115	
			5×1	4750	11860		284											143	
40	10	6.35	3.5×1	4130	10560	64	155	104	18	84	20	11	17.5	11	38	22	PT1/8"	125	
			5×1	5050	13340		175											155	
	12	6.35	2.5×1	3180	7780	64	141	165	104	18	84	20	11	17.5	11	38	22	PT1/8"	95
			3.5×1	4130	10560		189												125
	16	6.35	2.5×1	3180	7780	64	173	104	18	84	20	11	17.5	11	38	22	PT1/8"	95	
			3.5×1	4130	10560		205											125	
	16	7.144	2.5×1	3740	8790	64	173	104	18	84	15	11	17.5	11	38	22	PT1/8"	98	
			3.5×1	4870	11930		205											128	
	20	6.35	1.5×1	2180	5000	64	164	104	18	84	20	11	17.5	11	38	22	PT1/8"	64	
			2.5×1	3180	7780		204											95	
	20	6.35	3.5×1	4130	10560	64	244	104	18	84	20	11	17.5	11	38	22	PT1/8"	125	
			5×1	5050	13340		284											155	
40	6.35	1.5×1	2180	5000	64	242	104	18	84	20	11	17.5	11	38	22	PT1/8"	64		

# FDVE

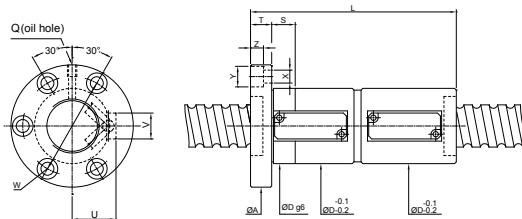

Unit: mm

SCREW SIZE		BALL DIA.	EFFECTIVE TURNS circuit × row	BASIC RATE LOAD(kgf)		NUT		FLANGE			FIT			BOLT		RETURN TUBE		OIL HOLE	STIFFNESS
O.D.	LEAD			Dynamic (1×10 <sup>6</sup> REV.) Ca	Static Co	Dg6	L	A	T	W	S	X	Y	Z	U	V	Q	kgf/μm	
50	10	6.35	3.5×1	4560	13230	73	155	118	18	96	20	11	17.5	11	43	22	PT1/8"	149	
			5×1	5580	16710	175	185												
	12	6.35	2.5×1	3510	9750	152												112	
			3.5×1	4560	13230	73	176	118	18	96	20	11	17.5	11	43	22	PT1/8"	149	
	12	7.144	5×1	5580	16710	200												185	
			2.5×1	4080	11260	161													114
	16	6.35	3.5×1	5300	15280	75	185	122	20	98	15	14	20	13	44	24	PT1/8"	151	
			5×1	6480	19300	209													187
	16	7.144	2.5×1	3510	9750	174													112
			3.5×1	4560	13230	73	206	118	18	96	20	11	17.5	11	43	22	PT1/8"	149	
	20	7.144	5×1	5580	16710	238													185
			2.5×1	4080	11260	180													114
20	7.938	3.5×1	5300	15280	75	212	122	20	98	15	14	20	13	44	24	PT1/8"	151		
		5×1	6480	19300	244													187	
50	7.938	1.5×1	2790	7240	179													77	
		2.5×1	4080	11260	219													114	
50	7.938	3.5×1	5300	15280	75	259	122	20	98	15	14	20	13	44	20	PT1/8"	151		
		5×1	6480	19300	299													187	
50	7.938	2.5×1	4750	12090	219													117	
		3.5×1	6180	16400	76	259	123	25	99	20	14	20	13	46	25	PT1/8"	154		
50	7.938	5×1	7550	20720	299													191	
		1.5×1	3250	7770	76	305	123	25	99	20	14	20	13	46	25	PT1/8"	79		

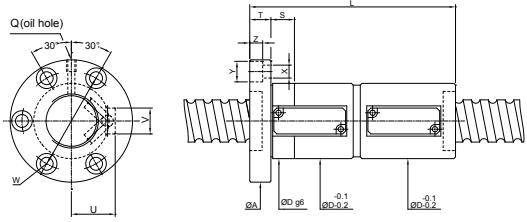

Unit: mm

SCREW SIZE		BALL DIA.	EFFECTIVE TURNS circuit × row	BASIC RATE LOAD(kgf)		NUT		FLANGE			FIT		BOLT		RETURN TUBE		OIL HOLE	STIFFNESS	
O.D.	LEAD			Dynamic (1×10 <sup>6</sup> REV.)	Static	Dg6	L	A	T	W	S	X	Y	Z	U	V	Q	kgf/μm	
				Ca	Co														
63	10	6.35	3.5×1	5030	17020	86	155	133	22	108	20	14	20	13	49	24	PT1/8"	178	
			5×1	6150	21500	175	220												
	12	6.35	2.5×1	3870	12540	153												134	
			3.5×1	5030	17020	86	177	133	22	108	20	14	20	13	49	24	PT1/8"	178	
	12	7.144	5×1	6150	21500	201												220	
			2.5×1	4540	14460	158													136
	12	7.144	3.5×1	5900	19620	87	182	134	22	110	20	14	20	13	50	25	PT1/8"	180	
			5×1	7210	24780	206													224
	16	7.144	2.5×1	4540	14460	177													139
			3.5×1	5900	19620	87	209	134	22	110	20	14	20	13	50	25	PT1/8"	184	
	16	7.938	5×1	7210	24780	241													228
			2.5×1	5260	15430	207													134
20	6.35	3.5×1	6840	20940	89	239	148	28	118	25	18	26	17.5	52	25	PT1/8"	178		
		5×1	8360	26450	271													220	
20	7.938	2.5×1	3870	12540	205													134	
		3.5×1	5030	17020	86	245	133	22	108	20	14	20	13	49	24	PT1/8"	178		
20	9.525	5×1	6150	21500	285													220	
		2.5×1	5260	15430	221													139	
20	9.525	3.5×1	6840	20940	89	261	148	28	118	25	18	26	17.5	52	25	PT1/8"	184		
		5×1	8360	26450	301													228	
20	9.525	2.5×1	8870	25870	219													158	
		3.5×1	11530	35110	93	259	152	28	122	25	18	26	17.5	54	28	PT1/8"	208		
80	10	6.35	5×1	14090	44350	299												258	
			3.5×1	5630	21660	103	159	150	22	126	20	14	20	13	58	25	PT1/8"	207	
5×1	6880	27360	179	179	256														
80	12	7.938	3.5×1	7670	27030	184												222	
			5×1	9380	34140	123	208	170	22	146	20	14	20	13	66	28	PT1/8"	275	
80	16	9.525	2.5×1	9900	33200	188												189	
			3.5×1	12990	45050	126	220	185	28	155	30	18	26	17.5	70	28	PT1/8"	251	
80	20	9.525	5×1	15880	56910	252												311	
			2.5×1	9900	33200	220													189
100	16	9.525	3.5×1	12990	45050	126	260	185	28	155	30	18	26	17.5	70	28	PT1/8"	251	
			5×1	15880	56910	300													311
100	20	9.525	2.5×1	11320	41820	211												213	
			3.5×1	14720	56750	146	243	217	32	181	30	22	32	21.5	82	35	PT1/8"	283	
100	20	9.525	5×1	17990	71690	259												351	
			2.5×1	11320	41820	228													213
100	20	9.525	3.5×1	14720	56750	146	268	217	32	181	30	22	32	21.5	82	35	PT1/8"	283	
			5×1	17990	71690	308													351